

# Plat of Survey

of

## Lot 8 of Green Lake Subdivision,

located in the Northwest 1/4 of Section 25, Town 4 North, Range 16 East, Town of LaGrange, Walworth County, Wisconsin.

Surveyed for:

**John Kuban**

W5180 Jason Road  
Elkhorn, Wisconsin. 53121

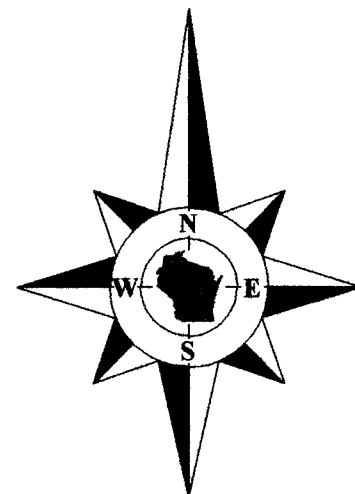

Bearings reference to the plat  
of Green Lake Subdivision.

Lot 7

Lot 8

**Tax Parcel  
HGS 00008**

0.542 Acre  
23,610 Sq.Ft.

Septic system located  
in back yard.

**House  
W5180**

Well

Lot 9

**Jason Road**

(66' Wide)

**United States Highway 12**

(66' Wide)

"There shall be no direct vehicular ingress  
or egress with U.S. Highway 12."  
Note as shown on the plat of  
Green Lake Subdivision.

**Viola Corner Easement**  
As shown on the plat of  
Green Lake Subdivision.

S37°02'53"E 99.99'  
(837°04'27"E 100.00')

Overhead Wire

Fence corner  
on line corner

85' Building Setback Line  
As shown on the plat of  
Green Lake Subdivision.

Chain Link Fence

S52°55'33"W 246.27'  
(S52°55'33"W 246.19')

N0°12'18"E 27.96'  
(N0°12'18"E 27.86')

Radius=68.00' Chord=93.03'  
(68.43')

N08°19'27"E 77.88'  
(N08°19'27"E 77.88')

N52°53'45"E 227.00'  
(N52°55'33"E 227.00')

DEC 3 2013

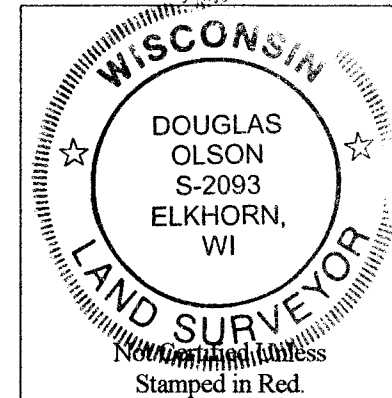

Copyright 2013 by Jensen & Olson Land Surveying, LLC.

All rights reserved. No part of this survey plat may be reproduced or transmitted in any form by any means - graphic, electronic, or mechanical, including photocopying, tracing, or information storage and retrieval systems - without permission in writing from Douglas G. Olson, Jensen & Olson Land Surveying, LLC.

### Notes:

- 1) This survey plat is not certified unless signed and sealed in red ink.
- 2) This survey is subject to Wisconsin lien laws. This Plat of Survey is the notice of intent to file lien. Lien waiver required.

I, Douglas G. Olson, Wisconsin Registered Land Surveyor, do hereby certify that this survey was performed by me, or under my direction in full compliance with the owner's/agent's instructions and Chapter A-E 7 of the Wisconsin Administrative Code "Minimum Standards for Property Surveys"; and that this map is an accurate representation thereof to the best of my knowledge and belief.

Douglas G. Olson  
Wisconsin Registered Land Surveyor - 2093

Survey Date: November 7, 2013.  
Revisions:

Scale in Feet  
1" = 20'

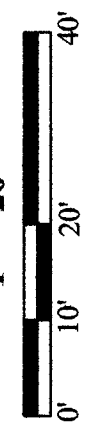

**Jensen & Olson Land Surveying, LLC**  
45 South Wisconsin Street \* P.O. Box 322 \* Elkhorn, Wisconsin. 53121  
Telephone: (262) 723-3434 \* Facsimile: (262) 723-8044  
Email: jensen.olson@elknet.net

**Legend**  
● Found Iron Rod  
○ Set Iron Pipe, 1" dia.  
○ Recorded Information  
x Utility Pole or Pedestal  
○ Concrete Cover or Septic Vent  
Asphalt Surface  
Concrete Surface Gravel

Sheet 1 of 1 Sheets  
Drawing Name: eld16-2013123-123.sj  
Job Reference Number  
**2013.123**

2013.123

HGS -8 416-2678